



NEWSLETTER

4-H EDUCATOR: JEN MATOSKY

Email: jmatosky@uwyo.edu Phone: 307-367-4380

<https://www.wyoming4h.org/4hsublette/>

OCTOBER 2022

UPCOMING EVENTS

October 1: New 4-H Year starts

November 4: Achievement Night

October 2-8: National 4-H Week

November 11: OFFICE CLOSED

October 4: Pinedale Open House

- Veteran's Day 

October 5: Big Piney Open House

November 24-25: OFFICE CLOSED

October 24: Friend of 4-H &

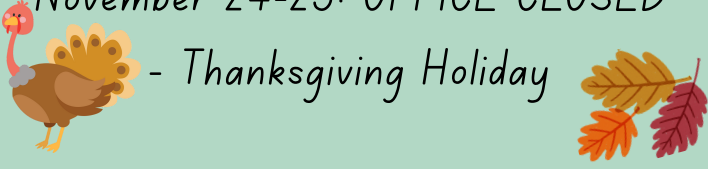
- Thanksgiving Holiday 

Outstanding Leader Nominations Due 

IT'S 4-H ENROLLMENT TIME!

The 2022-2023 4-H year has officially started! That means it is time to enroll or re-enroll if you are a 4-H member, or volunteer leader! Instructions on how to enroll are on pages 5 - 7.

The 4-H Council voted to change enrollment fees. 4-H registration fees are now \$20/member. First year members are \$10, but should make sure to sign up for the "First Year Member Club" in ZSuite so the fee is discounted.

Shooting sports members will also have a \$20/discipline fee. Enrollment fees are due at the time of enrollment and can be paid through ZSuite or cash or cash at the office. 

You must be enrolled with **ACTIVE** status on ZSuite in order to participate in 4-H activities. You are not covered under 4-H insurance until you have **ACTIVE** status.

National 4-H Week is October 2-8! Don't miss celebrating with the various events and contests going on through the week! You can find them on page 2.

-Jen Matosky

We are looking for nominations for our Outstanding Leader and Friend of 4-H awards!

Nominations are due October 24th. The person receiving this award will be recognized at Achievement Night on November 4th.

Outstanding Leader form:

<https://forms.gle/bJjaJtz3gdnyL5gm6>

Friend of 4-H form:

<https://forms.gle/XmRpDo4jwqt8n45h9>



October Birthdays

- Emery Blaha
- Neil Bousman
- Karlee Bowles
- Emma Brown
- Cactus Chrisman
- Chelsea Davis
- Mari Draney
- Colten Draney
- Weston Eiden
- Myka Gillett
- Trig Greene
- Brantley Hale
- William Hibbert
- Swayzie Jensen
- Jolynn Jones
- Matazie Jones
- Leland Jones
- Oz Koci
- Travis Reed
- Jolien Robertson
- Shane Rogers
- Reuben Stoutenburg
- Taysen Tibbitts
- Maggie Williams

"Through your emphasis on head, heart, hands and health you are making a valuable contribution to our country's welfare and progress."

-President John F. Kennedy



National 4-H WEEK



October 2-8, 2022

#SUBLETTECOUNTY4H

MONDAY



10/3

Thank a 4-H Volunteer Day!

Thank you!

Send them a card, give them a shout out on social media, buy them lunch, get creative and find a way to thank your 4-H leader!

TUESDAY

Sublette County 4-H 

Open HOUSE

Come learn about what 4-H has to offer or enroll for the new 4-H year!

Extension Office

Tuesday, October 4th from 5:30-7:30pm

Marbleton Town Hall

Wednesday, October 5th from 5:30-6:30pm

WEDNESDAY

THURSDAY



10/6

T-shirt Thursday

Wear your 4-H apparel!

FRIDAY

10/7

Candy Jar Contest

Guess how many candies are in the jar at the Extension Office or Open Houses throughout the week. The winner will be announced Friday and will receive a \$25 Gift Card!

What's your guess?



2022



Sublette
County 4-H

*Achievement
Night*

PLEASE JOIN US TO CELEBRATE
OUR 4-H YOUTH & VOLUNTEERS!

Friday, November 4th, 2022

6:30 PM

Sublette County Fair Grounds
Events Center
Big Piney, Wyoming



CLUBS

LABARGE
Beef Feeders
Lisa Jones
 Beef
 Poultry

BOULDER
Boulder Buckskins
Cody & Danielle Post
 Beef Horse Leather

BONDURANT
North Star Feeders
Stacy Saunders
 Beef Goats
 Rabbits Sheep
 Swine Cloverbuds

BIG PINEY

Barnyard Bunch
Callie Whinnery
 Goats
 Poultry
 Sheep
 Swine

Big Piney Vet Science
Debbie Jones
 Veterinary Science

Dead Eye Shooters
Jim Johnson
 .22 Rifle - Callie Whinnery
 Archery - Preston Schell
 Matt Forrester
 Norlin Sage
 Muzzleloading - Roger Clark
 Jim Johnson
 Shotgun - Roger Clark
 Jim Johnson

Helping Hands
Grace Delker
 Photography
 Visual Arts
 Leathercraft
 Fabric & Fashion
 Woodworking
 Cats
 Dogs
 Poultry
 Rabbits

Cattle Kids
Jana Hughes
Kailey Barlow
 Beef

Horses-R-Us
Brent & Kristi Hibbert
 Horses

PINEDALE

Pinedale Community Club: Leader Needed
 Aerospace - Jamie Walker
 Cake Decorating - Cheyenne Sterck
 Crocheting - Jamie Walker
 Interior Design - Sandy Wanfalt
 Photography - Sandy Wanfalt
 Quilting - Erica Bohnet
 Fabric & Fashion - Jena Prior
 Range - Russell & Bree Burton
 Visual Arts - Sandy Wanfalt

Young Guns Shooting Sports: Russell Burton
 .22 Pistol - Dean Leathers
 Anthony Rigo
 Travis Bingham
 .22 Rifle - Anthony Rigo
 Audra Rouge
 Air Rifle - Dan Wanfalt
 Anthony Rigo
 Audra Rouge
 Air Pistol - Dean Leathers
 Anthony Rigo
 Travis Bingham
 Archery - Russell & Bree Burton
 David Rouge
 Muzzleloading - Greg Allen
 Gregory Allen
 Shotgun - Ken Bailey
 Ron Hines
 Other Leaders - Jamie & Ryan Walker

Pinedale Livestock: Jen Hayward
(Must be enrolled by Feb. 1)
 Beef - Audra Rouge Horses - Jen Hayward
 Goats Sheep - Starr Avery-Kuhn
 Poultry Swine
 Other Leaders - Kari Bousman Gary Hayward
 Dale Kaan Tiffany & Clay Olson

Wind River Masters: Dru Rogers
 Beef Swine - Barry Layne
 Goats Other Leaders -
 Sheep Jenna & Phil Mergl
 Mary Leathers

Pinedale XC Ski Club
Leader Needed
 Youth 5-18 years old

Pinedale Cloverbuds
Leader Needed
 Youth 5-7 years old

Pinedale Robotics
Jamie Walker
KaLee Bohnet

Wind River Riders
Stuart Thompson
 Horses



ZSuite 4-H Enrollment

New Family Profile



If you've never signed in to ZSuite before, follow these steps:

1. Go to <https://4h.zsuite.org/>
2. As a Family creating a new Profile, select **SIGN UP**
 - a. Fill in all of the fields, select **LET'S GO!**

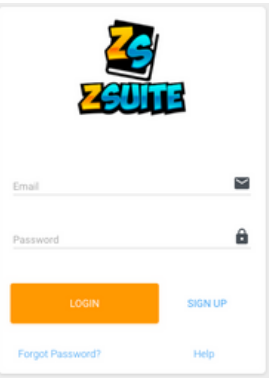

Adding 4-H Members

You are now on the **Dashboard** tab

1. Select **+ Household Member**
2. Fill out 4-H Member's info, select **Continue**
3. Fill out PERSONAL INFO, select **Next**
4. Fill out all six drop down WAIVERS, then select **Next**
5. Dropdown to your CLUB, select **Add Club**
select **Add Project**

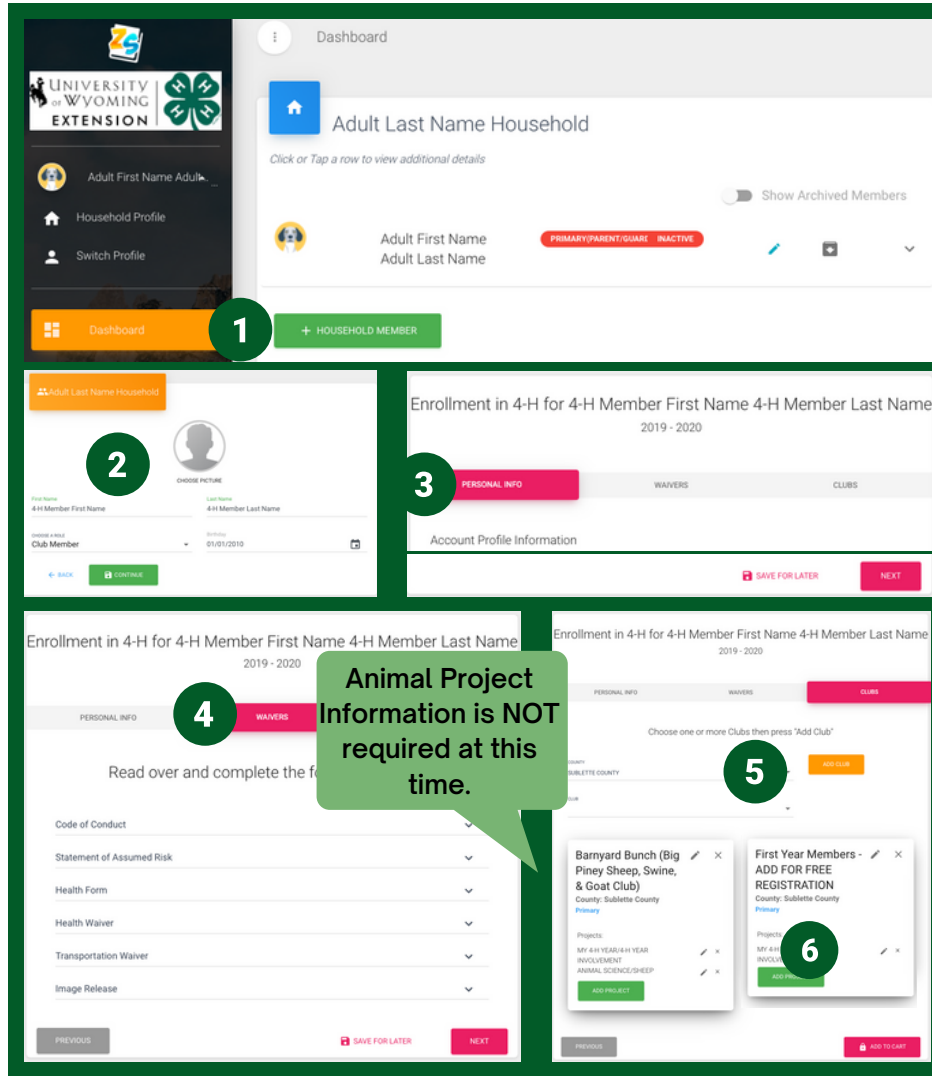

If you are interested in Junior Leaders Livestock Judging Team Livestock Skillathon Team make sure to add them as a Club.

6. Select **Add to Cart** and then you can either **+Add Enrollment** or **Submit**. Must be submitted to be complete.

First Year 4-H Members, make sure to add the First Year Member "Club". This will add a discount on your enrollment fees.

If you need assistance, don't hesitate to select the ZSuite LIVE CHAT!

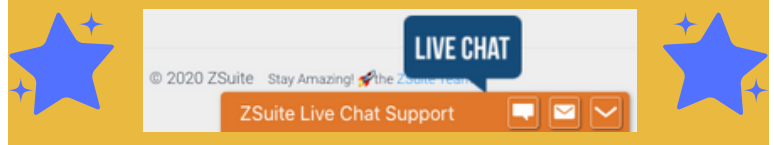

Once submitted, your Enrollment will change from Pending Approval to Active when the Extension Office receives payment!

ZSuite 4-H Enrollment

Existing Family Profile



Enrollment must be done **ANNUALLY** to stay active in 4-H!

Go to <https://4h.zsuite.org/>

1. Use the same email & password you used to sign up, select **LOGIN**
2. Choose the **PRIMARY ACCOUNT** to enroll 4-H Members
3. You will see a list of the household members & their current enrollment status.
 - a. **Red = INACTIVE 4-H Member**
 - b. **Green = ACTIVE 4-H Member**
4. Select the 4-H Member's Name you wish to update, select **ENROLL MEMBER NOW**
5. **IF YOU DO NOT SEE A NAME LISTED**, You will need to ADD A HOUSEHOLD MEMBER

First Year 4-H Members, make sure to add the First Year Member "CLUB". This will add a discount on your enrollment fees.

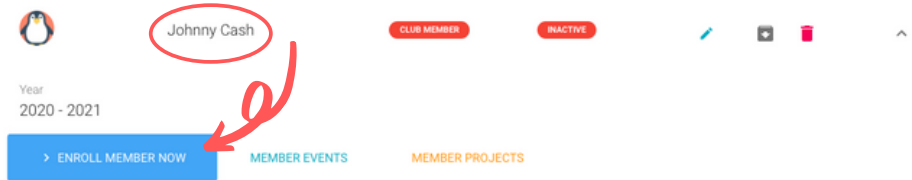

6. Fill out 4-H Member's info, select **Continue**
 Fill out PERSONAL INFO, select **Next**
 Fill out all six drop down WAIVERS, then select **Next**
 Dropdown to your CLUB, select **Add Club**
 - a. Select **Add Project**

If you are interested in
Junior Leaders
Livestock Judging Team
Livestock Skillathon Team
make sure to add them as a Club.

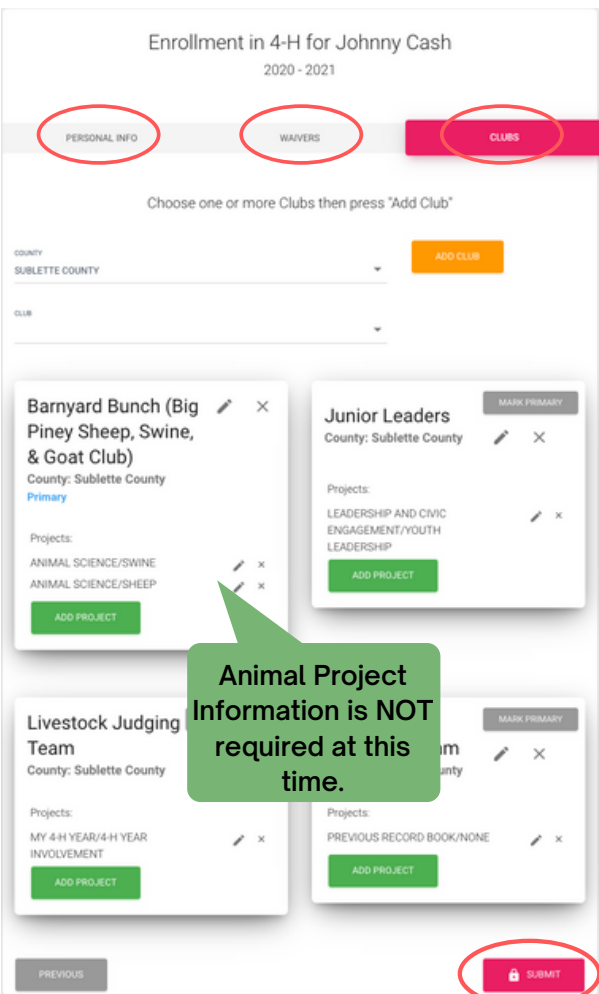
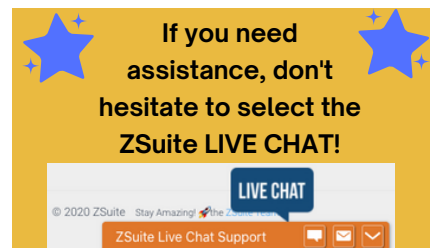

7. Select **Add to Cart** and then you can either **+Add Enrollment** or **Submit**. Must be submitted to be complete.

Once submitted, your Enrollment will change from Pending Approval to Active when the Extension Office receives payment!

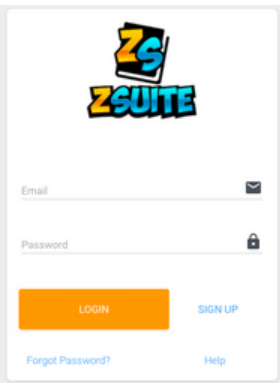

ZSuite 4-H Enrollment

New Leader Profile



Enrollment must be done **ANNUALLY** to be an **Active** 4-H Leader!

1. Go to <https://4h.zsuite.org/>
2. To create a new Profile, select **SIGN UP**
 - a. Fill in all of the fields, select **LET'S GO!**

If you've signed in before,
LOGIN
 Select **PRIMARY ACCOUNT**

Volunteer Enrollment

You are now on the **Dashboard** tab

- 1 Select the Volunteer's Name
- 2 More content will drop down, select **Enroll Volunteer Now**
- 3 Select **Complete Volunteer Enrollment**
- 4 Fill out all of the of the **Personal Info**
 - a. When filling out *Volunteer Roles/Opportunities*, select all that may apply.
- 5 Complete all Waivers
- 6 Dropdown to your CLUB, select **Add Club**
 - a. Select **Add Project** if needed
- 7 Select **Add to Cart** and **Continue**

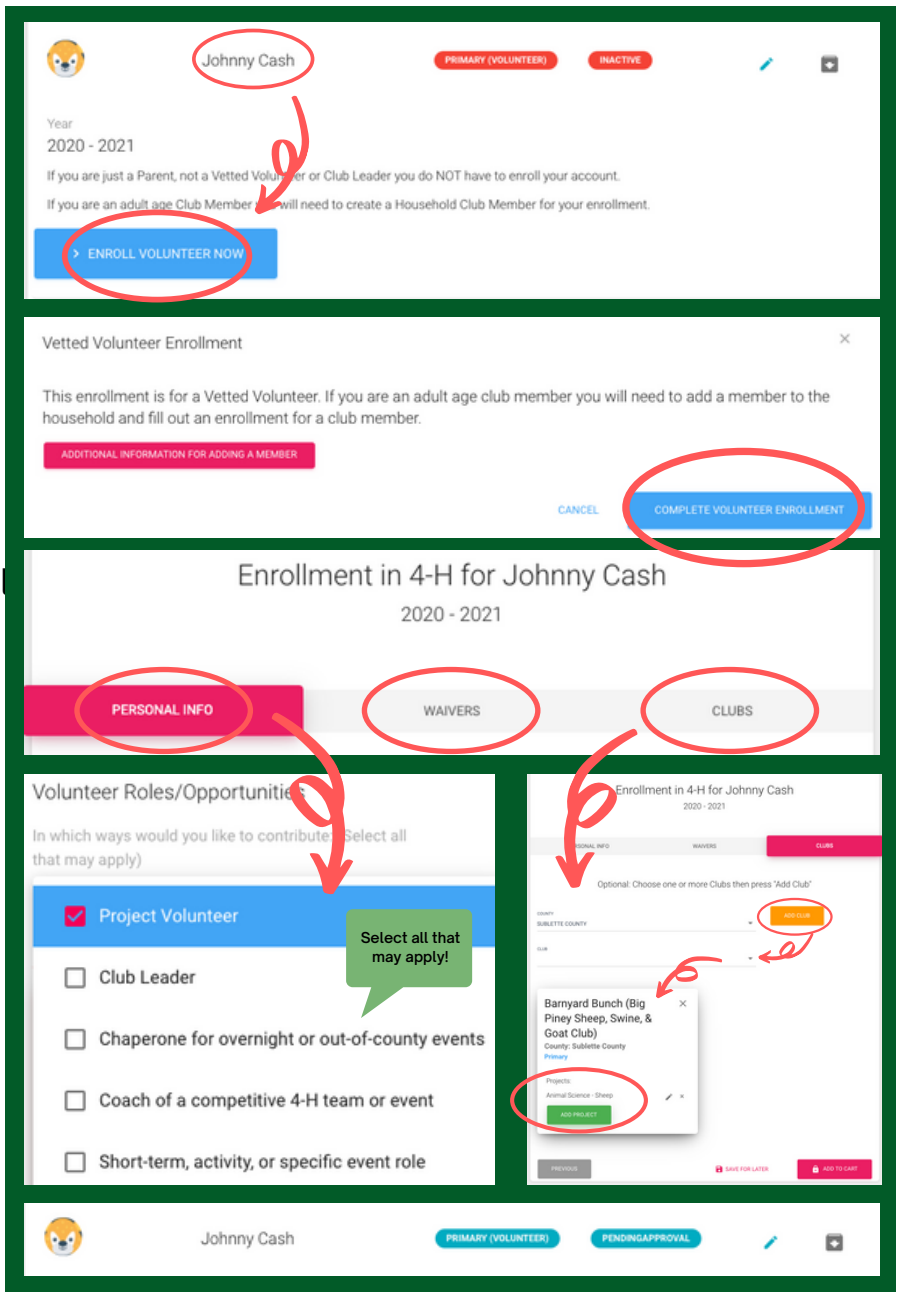

Once submitted, your Enrollment will change from Pending Approval to Active when you have completed:

- **Background Screening**
 - Look for the State 4-H Office email
- **New Volunteer Orientation**
 - Visit <https://extension.catalog.instructure.com/> to create a login, then go to <https://uwyo3.instructure.com/login/canvas> to complete the course.
- **MVR (Motor Vehicle Records) *optional** - only needed if you plan to transport 4-H members
 - Visit https://www.wyoming4h.org/4hsublette/?page_id=2097 to complete
 - "Supervisor/Sponsor" - Johnathan Despain - jdespain@uwyo.edu
 - "Additional Email Addresses to Notify" - karen.allison@uwyo.edu

If you need assistance, don't hesitate to select the **ZSuite LIVE CHAT!**